

6"

140 REC66

PANELLI®

CARATTERISTICHE IDRAULICHE - HYDRAULIC PERFORMANCES

Q= Portata - Capacity - Debit **50 Hz n= 2900 min**

Tipo Type	Power		H(m)	l/min	600	800	1000	1200	1400	
	kW	HP		l/sec	0	10	13,33	16,67	20	23,33
				m³/h	0	36	48	60	72	84
140 REC 66/3	5,5	7,5	39	29	26	23	17	6		
140 REC 66/4	7,5	10	52	39	35	31	23	8		
140 REC 66/5	9,2	12,5	65	49	44	39	29	10		
140 REC 66/6	11	15	78	59	53	47	34	12		
140 REC 66/7	13	17,5	91	69	62	55	40	14		
140 REC 66/8	15	20	104	78	70	62	46	16		
140 REC 66/9	15	20	117	88	79	70	51	18		
140 REC 66/10	18,5	25	130	98	88	78	57	20		
140 REC 66/11	22	30	143	108	97	86	63	22		
140 REC 66/12	22	30	156	118	106	94	68	24		
140 REC 66/13	22	30	169	127	114	101	74	26		
140 REC 66/14	26	35	182	137	123	109	80	28		
140 REC 66/15	26	35	195	147	132	117	86	30		
140 REC 66/16	30	40	208	157	141	125	91	32		
140 REC 66/17	30	40	221	167	150	133	97	34		
140 REC 66/18	37	50	234	176	158	140	103	36		
140 REC 66/19	37	50	247	186	167	148	108	38		
140 REC 66/20	37	50	260	196	176	156	114	40		
140 REC 66/21	37	50	273	206	185	164	120	42		

DIMENSIONI D'INGOMBRO E PESI - OVERALL DIMENSIONS AND WEIGHTS

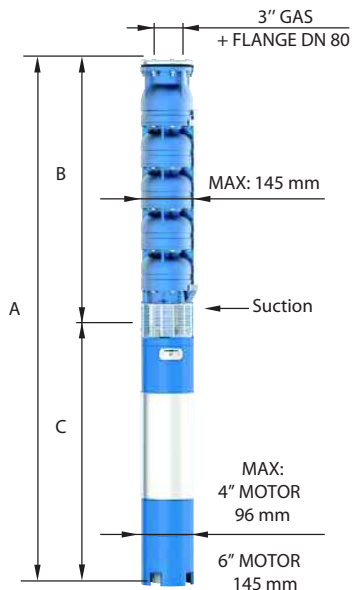

Type	A mm Tri V 400	B mm	C mm Tri	M Kg Tri	P Kg
140 REC 66/3	1285	614	671	45	21
140 REC 66/4	1422	721	701	55	25
140 REC 66/5	1579	828	751	60	30
140 REC 66/6	1746	935	811	65	34
140 REC 66/7	1883	1042	841	70	39
140 REC 66/8	2080	1149	931	75	43
140 REC 66/9	2187	1256	931	75	48
140 REC 66/10	2354	1363	991	83	52
140 REC 66/11	2541	1470	1071	92	57
140 REC 66/12	2648	1577	1071	92	61
140 REC 66/13	2755	1684	1071	92	66
140 REC 66/14	2972	1791	1181	100	70
140 REC 66/15	3079	1898	1181	100	75
140 REC 66/16	3256	2005	1251	108	79
140 REC 66/17	3363	2112	1251	108	84
140 REC 66/18	3560	2219	1341	118	88
140 REC 66/19	3667	2326	1341	118	93
140 REC 66/20	3774	2433	1341	118	97
140 REC 66/21	3881	2540	1341	118	102

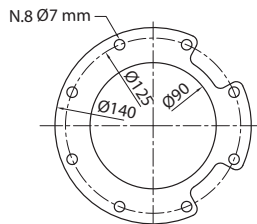

FOR COMMERCIAL TUBE
EXTERNAL DIAMETER: 88,9 mm

n% = Rendimento della pompa
n% = Rendement de la pompe
n% = Pump efficiency
n% = Rendimiento de la bomba

**Max
74%**

kW/st = Assorbimento per stadio
kW/st = Absorption par étage
kW/st = Stage absorption
kW/st = Potencia absorbida por etapa

**Max
1,74**

Tolleranza alla sabbia 50 g/m³ - Sand tolerance 50 g/m³
Tolleranze secondo UNI ISO 9906 livello 3B - Tolerances according to UNI ISO 9906 grade 3B

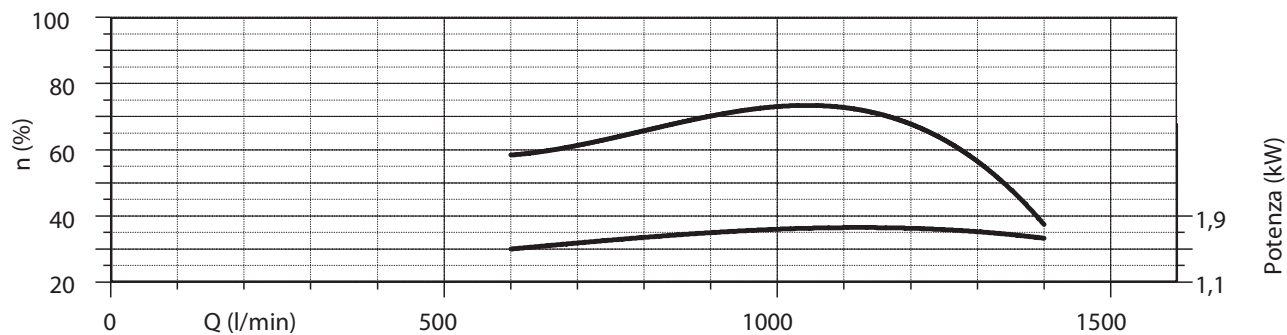
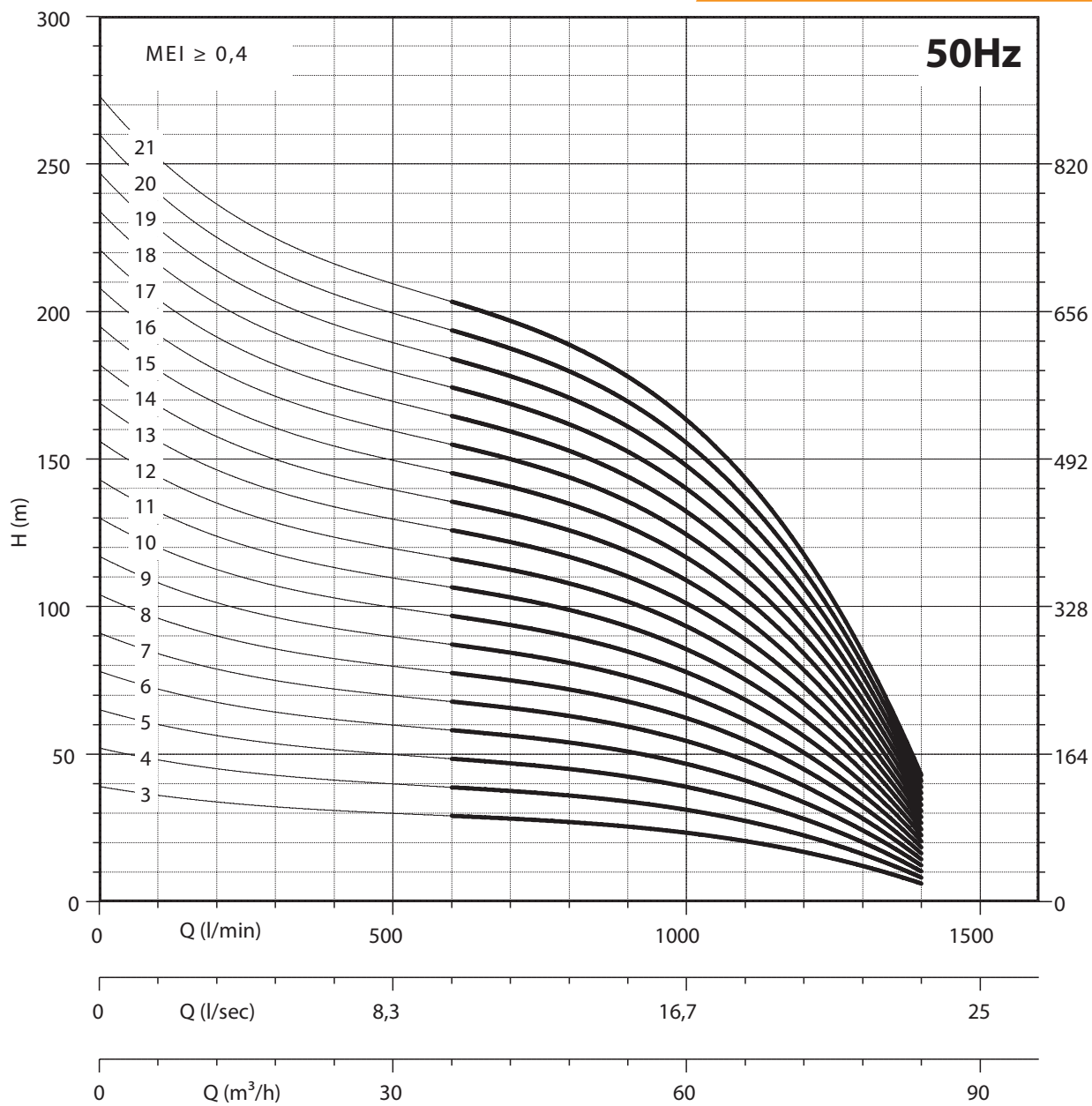

NPSH (m)	25%	50%	75%	100%
140 REC 66	3,8	3,8	5,1	7,1